

# Multiline Printing Tool

## Manual

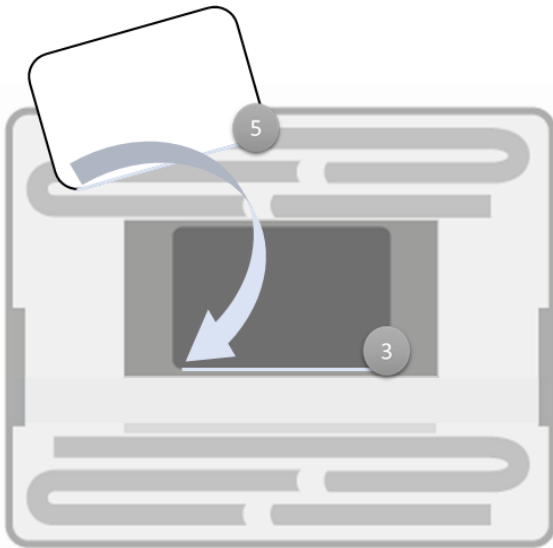

### **Step 1**

Position the card (5) along the lower edge of the insert (3).

**!Attention!** Please ensure that both the insert and the card are in their respective positions and that no edges protrude.

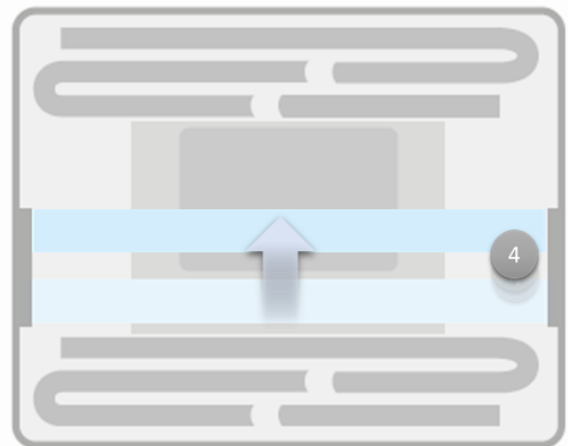

### **Step 2**

Slide the metal rail (4) to the top position.

**!Important!** The COLOP e-mark sensor detects the movement on the metal rail.

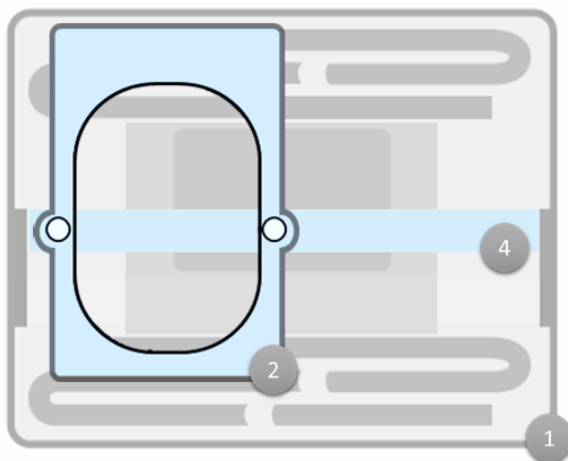

### **Step 3**

Insert the slide (2) into the frame of the Multiline Printing Tool (1) at the top left.

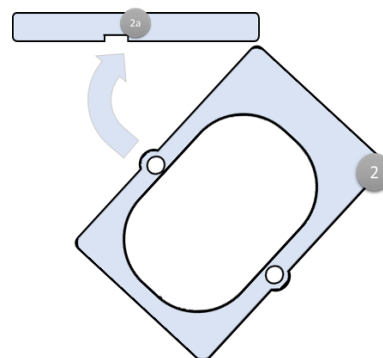

**!Attention!** Make sure that the metal rail is inside the recess on the underside (2a) of the slide (2).

# Multiline Printing Tool

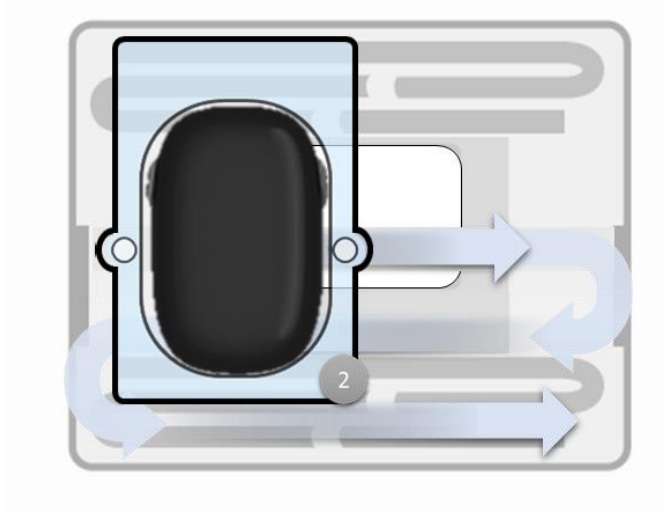

## **Step 4**

Place your COLOP e-mark in the slide (2) and drive along the specified track with an even as possible movement.



## **Step 5**

After completing the printing process, simply put the COLOP e-mark back in the docking station. To make it easier to remove the card (5), we recommend lifting the slide (2).